

# BASO 4.0

## DIRECT



### CERTIFICATIONS & COMPLIANCE



### FEATURES

**5 YEAR**  
limited  
led warranty

**Declare.**  
Red List Approved

**Armstrong**  
COMPATIBLE

### PERFORMANCE

- Up to 111lm/W efficiency
- 500 / 955 lm/ft
- CRI > 80 & CRI > 90
- IC & Damp rated

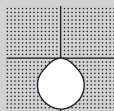

### MOUNTING

Recessed

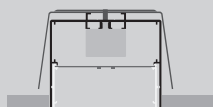

**FIELD-CUTTABLE FLEX**  
Down to 1/16"

[link to video](#)

### 10 Business Days for all QuickShip items

- Maximum quantity: 400'
- "QuickShip" must be clearly listed on PO.
- QuickShip items must be on Separate Purchase Order.
- QuickShip orders must be received with complete and correct catalog numbers.
- Variant request will not qualify for QuickShip program.
- QuickShip orders must be received before 2 pm EST. After 2 pm, shipping will be based on the next business day.
- QuickShip orders are based on standard BASO Lighting terms for payment.
- Order change of any type will affect shipping times.
- Partial shipments may be required based on current factory inventory.

### Catalog Number Example

BASO4.0-RTR-BL-30K-C80-UNV-010V-500LF-ST-48IN

A B C D E F G H J K

### A RANGE

**QS** BASO 4.0 BASO 4 . 0

### B MOUNTING

**QS** Recessed trimless R T L

**QS** Recessed with trim R T R

**QS** 9/16" Grid (any brand) 9 G R

**QS** 9/16" Slot Grid (any brand) 9 S G

**QS** 15/16" Grid (any brand) 1 5 G

### C COLOR

**QS** White W H

**QS** Black B L

### D CCT

**QS** 3000K 3 0 K

**QS** 3500K 3 5 K

### E CRI

**QS** CRI > 80 C 8 0

**QS** CRI > 90 C 9 0

### F VOLTAGE

**QS** 120V / 277V U N V

### G DIMMING

**QS** 0-10V 1% 0 1 0 V

### H OUTPUT LM/FT

**QS** 500lm/ft 100% 0 5 0 0 L F

**QS** 750lm/ft 100% 0 7 5 0 L F

**QS** 1000lm/ft 100% 1 0 0 0 L F

Custom lm/ft X X X X L F

custom lumen up to 1400 lm/ft

### I CIRCUIT / EM

**QS** Single circuit \*

### J SHAPE / PATTERN

**QS** Linear / straight S T

**QS** Linear / straight + flex inset S F

includes 1ft. field-cuttable section; only available for 4' and 8' segments

### K DIMENSIONS IN INCH

**QS** Linear 4' 4 8 I N

**QS** Linear 6' 7 2 I N

**QS** Linear 8' 9 6 I N

**QS** Custom length X X F T

(QS in 2' increments only)

Technical data

BASO 4.0 DIRECT					LUMEN OUTPUT MULTIPLIER*		
Delivered Lumens	CCT	CRI	Input Watts	Luminaire Efficacy	Color Temperature	CRI	
						80+	90+
500 lm/ft ↕	4000K	CRI > 80	4.1 W/ft	125 lm/W	4000K	1	0.86
750 lm/ft ↕	4000K	CRI > 80	6.1 W/ft	123 lm/W	3500K	0.96	0.84
1000 lm/ft ↕	4000K	CRI > 80	8.3 W/ft	120 lm/W	3000K	0.95	0.82
					2700K	0.91	0.78

\*To calculate the color temperatures >4000K and CRI 90, multiply the values in the lumen output tables.

Patterns top view

LINEAR

A	FIXTURES	CODE
48"	1'× 4' linear	ST - 0 4 F T
96"	1'× 8' linear	ST - 0 8 F T
144"	8' + 4' linear	ST - 1 2 F T

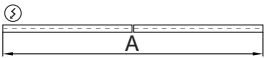

## DIMENSIONS

### BASO 4.0

#### RECESSED trimless

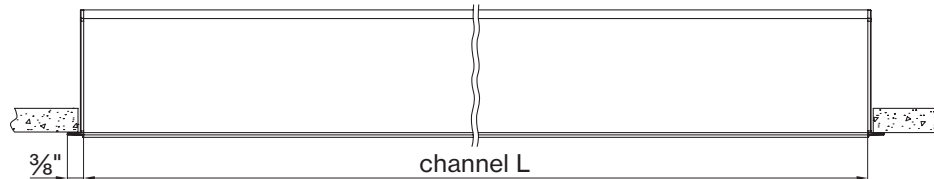
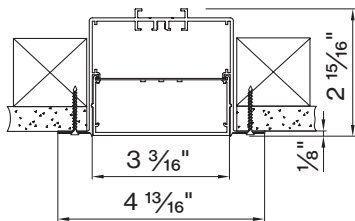

#### RECESSED with trim

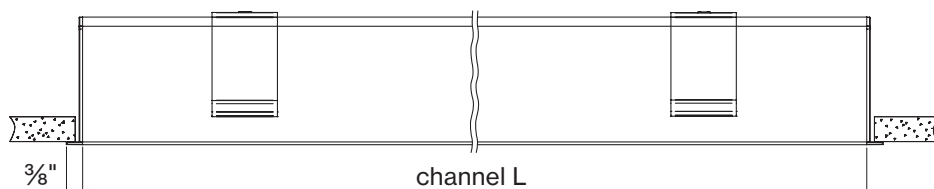
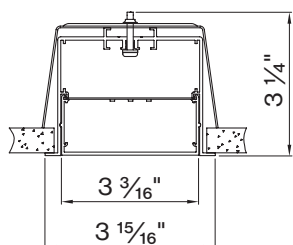

#### 1/16" T-GRID

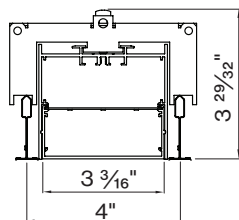

#### 1/16" Slot Grid (any brand)

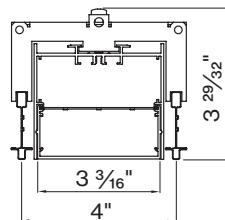

#### 1/16" Grid (any brand) 4ft / 15/16" Grid

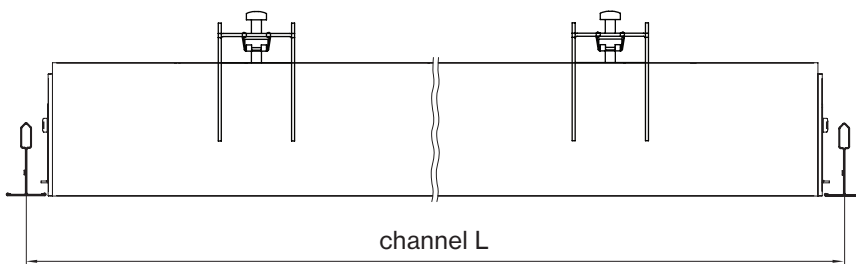

#### 15/16" T-GRID

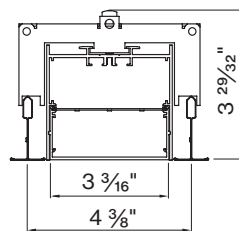

#### BASO mounting instructions

Get access to the BASO 4.0 mounting instructions faster by scanning the QR code.

[www.xalusa.com/resources/mounting-instructions/baso](http://www.xalusa.com/resources/mounting-instructions/baso)

