



# BASO 2.5

## PERIMETER

### CERTIFICATIONS & COMPLIANCE



### FEATURES

**5 YEAR**  
limited  
led warranty

**Declare.**  
Red List Approved

**Armstrong**  
COMPATIBLE

### PERFORMANCE

- Up to 106lm/W efficiency
- 455 / 750lm/ft
- CRI > 80 & CRI > 90
- IC & Damp rated

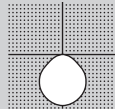

### MOUNTING

Perimeter

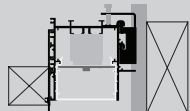

**FIELD-CUTTABLE FLEX**  
Down to 1/16"

[link to video](#)

### Catalog Number Example

BASO2.5-PM-RTR-BL-30K-C80-UNV-010V-0500LF-ST-48IN

A B C D E F G H I K L

### A RANGE

QS BASO 2.5 BASO2.5

### B SUB CATEGORY

QS Perimeter PM

### C MOUNTING

QS Recessed trimless R T L

QS Recessed with trim R T R

QS 9/16" Grid (any brand) 9 G R

QS 9/16" Slot Grid (any brand) 9 S G

QS 15/16" Grid (any brand) 1 5 G

### D COLOR

QS White WH

QS Black BL

### E CCT

QS 3000 K 3 0 K

QS 3500 K 3 5 K

### F CRI

QS CRI > 80 C 8 0

QS CRI > 90 C 9 0

### G VOLTAGE

QS 120V / 277V UN V

### H DIMMING

QS 0-10V 1% 0 1 0 V

### I OUTPUT LM/FT

QS 500lm/ft 100% 0 5 0 0 L F

QS 750lm/ft 100% 0 7 5 0 L F

QS 1000lm/ft 100% 1 0 0 0 L F

Custom lm/ft X X X X L F

custom lumen up to 1200 lm/ft

### J CIRCUIT / EM

QS Single circuit \*

### K SHAPE / PATTERN

QS Linear / straight S T

QS Linear / straight + flex inset S F  
includes 1ft. field-cuttable section; only  
available for 4' and 8' segments

### L DIMENSIONS IN INCH

QS Linear 4' 4 8 I N

QS Linear 6' 7 2 I N

QS Linear 8' 9 6 I N

QS Custom length X X F T

(QS in 2' increments only)

### 10 Business Days for all QuickShip items

- Maximum quantity: 400'
- "QuickShip" must be clearly listed on PO.
- QuickShip items must be on Separate Purchase Order.
- QuickShip orders must be received with complete and correct catalog numbers.
- Variant request will not qualify for QuickShip program.
- QuickShip orders must be received before 2 pm EST. After 2 pm, shipping will be based on the next business day.
- QuickShip orders are based on standard BASO Lighting terms for payment.
- Order change of any type will affect shipping times.
- Partial shipments may be required based on current factory inventory.

**BASO**  
basolighting.com

Technical data

BASO 2.5 DIRECT

Delivered Lumens	CCT	CRI	Input Watts	Luminaire Efficacy	LUMEN OUTPUT MULTIPLIER*		
					Color Temperature	CRI	
						80+	90+
500 lm/ft ↕	4000K	CRI > 80	4.1 W/ft	122 lm/W	4000K	1	0.86
750 lm/ft ↕	4000K	CRI > 80	6.3 W/ft	119 lm/W	3500K	0.96	0.84
1000 lm/ft ↕	4000K	CRI > 80	8.9 W/ft	112 lm/W	3000K	0.95	0.82
					2700K	0.91	0.78

\*To calculate the color temperatures >4000K and CRI 90, multiply the values in the lumen output tables.

Perimeter depth

field adjustable

FLUSH



REGRESSED 1"

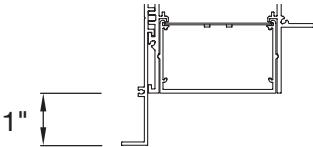

REGRESSED 2"

