

M-LINE DIRECT

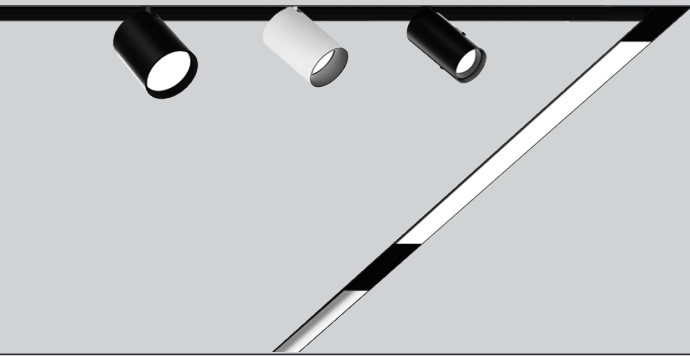

CERTIFICATIONS & COMPLIANCE



FEATURES



PERFORMANCE

- 48V low voltage track
- Multiple inset options
- CRI > 90+
- Flexible magnetic profile system

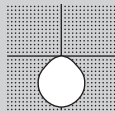

MOUNTING

Recessed

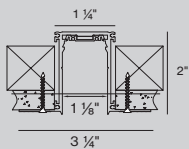

PATTERNS



*X Shapes Angular Curves Rectangular *T Shapes *Wall to Ceiling

For customization, please contact customer service

MAGNETIC ATTACHMENT

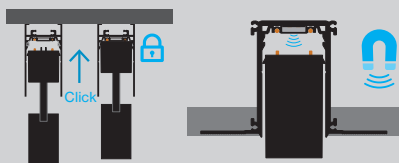

Catalog Number Example

MLTR1.2-RTL-BL-48V-010V-ST-02FT



A RANGE

M-LINE 1.2 MLTR 1 . 2

B MOUNTING

Recessed trimless RTL

C COLOR

Black BL

D VOLTAGE

48V 48V
constant voltage track

E DIMMING

QS 0-10V 1% single control 010V
0-10V 1% dual control* DC10

*two 0-10V dimming outputs

wiring diagram is on power supply page

F SHAPE / PATTERN

QS Linear ST
L-shape LS
□-shape (rectangular shape) RS
U-shape US
Z-shape ZS
Wall to ceiling WC
Custom shape XX

for more patterns, please consult
customer service (RCP required)

G DIMENSIONS IN FEET

Linear 2' 02FT
QS Linear 4' 04FT
Linear 6' 06FT
QS Linear 8' 08FT
linear custom ##FT
L-shape ##X##FT
custom
□-shape ##X##FT
custom
U-shape ##X##X##FT
custom
Z-shape ##X##X##FT
custom
dimensions starting at 2' in 1'
increments; for custom dimensions,
please consult customer service; track
not field-cuttable

Accessories

BLIND COVER
(field cuttable)



LENGTH
FT / INCH COLOR

4' black N50-4004008
8' black N50-4008008

M-LINE 1.2 channel dimensions

RECESSED

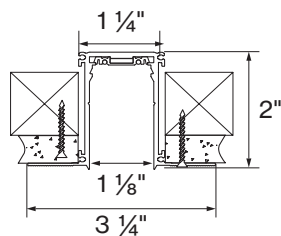

Possible shapes top view

please provide RCP to ensure correct shape orientation

LINEAR

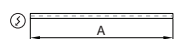

L-SHAPE

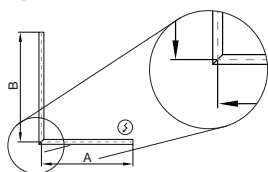

Z-SHAPE

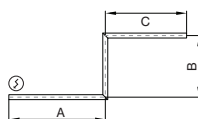

D-SHAPE

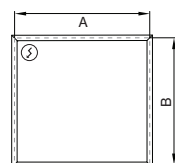

U-SHAPE

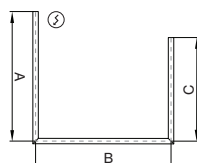

WALL TO CEILING

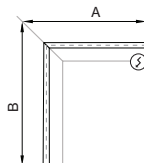

Power feeder locations

POWER FEED

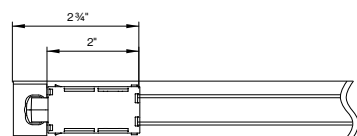

LINEAR POWER COUPLER

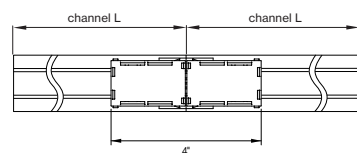

CORNER POWER COUPLER

SINGLE CONTROL (010V)

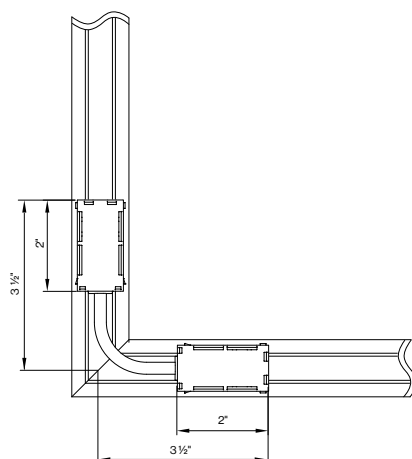

DUAL CONTROL (DC10)

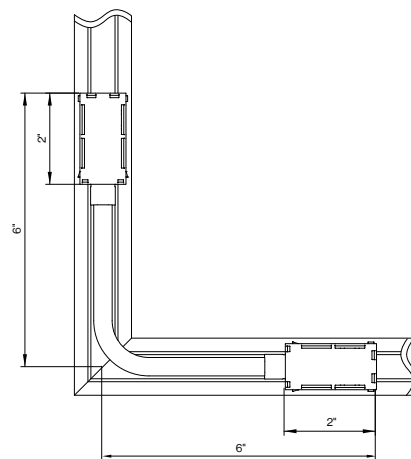

M-LINE Mounting Instructions

Get access to the M-LINE mounting instructions faster by scanning the QR code.

<https://www.basolighting.com/resources/mounting-instructions/m-line>

